

Sealed rechargeable Ni-MH Cylindrical cell

Specifications

Nominal voltage		1.2V	
Capacity (mAh)		0.2C discharge	0.5C discharge
	Minimum	4500	4350
	Typical	4580	4500
Dimensions (mm)	Diameter	$18.5^{+0.0}_{-0.5}$	
	Height	$72.0^{+0.0}_{-1.0}$	
Weight (g)	69		
Charge	Standard	450mA(0.1C)×16hrs	
	Rapid	2250mA(0.5C)×135mins or dV=-10mV	
Ambient temperature ()	Standard charge	0 to 45	
	Rapid charge	10 to 45	
	Discharge	-20 to 65	
	Storage	-10 to 45	

(CELL DIMENSIONS)

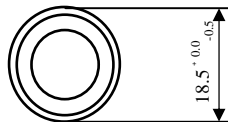
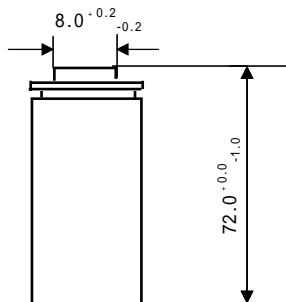

(With tube)

Charge Characteristics

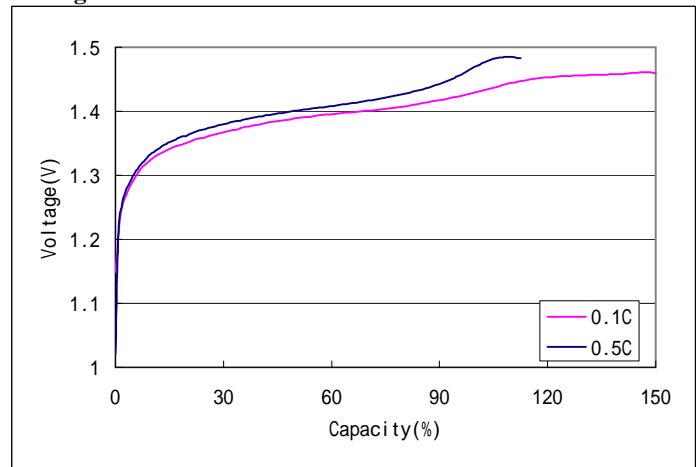

Discharge Characteristics

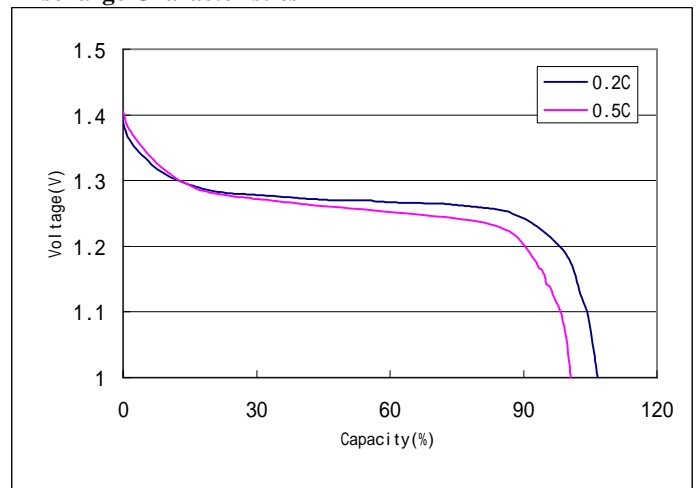

Cycle Characteristics

